

**Materials:** 22 gauge  
**Finish:** G90 galvanizing  
**Options:** See chart for Corrosion Finish Options

- Installation:**
- Use nails appropriate for intended use. See Product Notes, page 18.
  - The opposite end must be bonded in the mortar joint of brick facade.
  - Check local codes for spacing requirements.
  - Wall tie shall be bent at nail, bonding into mortar joint.

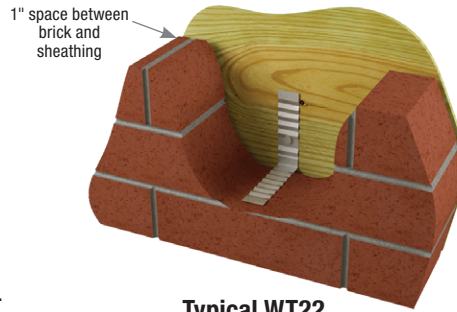

Typical WT22 installation

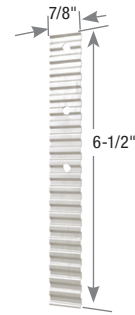

WT22

MiTek USP Stock No.	Ref. No.	Description	Steel Gauge	Dimensions (in)		Fastener Schedule <sup>1</sup>		Corrosion Finish	Code Ref.
				W	L	Qty	Type		
WT22	BTB	Straight Edge - Duplex	22	7/8	6-1/2	1	10d		--

1) **NAILS:** 10d nails are 0.148" dia. x 3" long.

**Corrosion Finish** ■ Stainless Steel ■ Gold Coat ■ HDG ■ Triple Zinc

## UMH Universal Masonry Hangers

A versatile solution for hanging beams from masonry walls. Face mount design allows hanger to be used with beam heights from 16" to 24". Available in a variety of widths for solid sawn, glulam, or engineered lumber beams.

**Materials:** 3 gauge  
**Finish:** Primer  
**Codes:** FL

- Installation:**
- Use all specified fasteners. See Product Notes, page 18.
  - Fully grouted and reinforced concrete block or cast-in-place concrete with a minimum of (1) #5 rebar continuous to footing with standard hook at bolt locations.
  - Minimum joist width is 3-1/2".

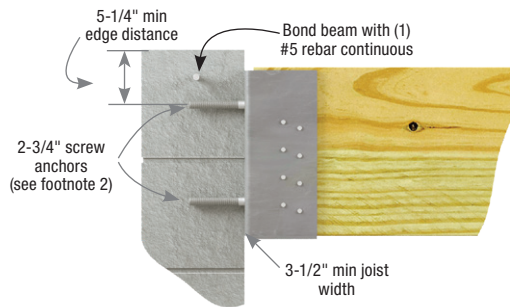

Typical UMH installation

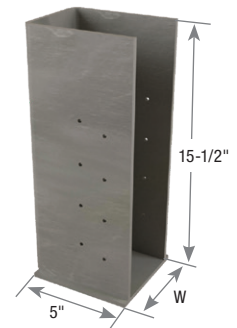

UMH

MiTek USP Stock No.	Ref. No.	Steel Gauge	W (in)	Fastener Schedule				DF/SP Allowable Loads (Lbs.)								Code Ref.
				Header <sup>2</sup>		Joist <sup>3</sup>		Masonry - 2,500 psi				Cast in Place Concrete - 3,000 psi				
				Qty	Screw Anchor	Qty	Type	Floor	Roof	Uplift <sup>1</sup>	100%	115%	125%	160%	Floor	
UMH358	MBHU3.56/16KT, MBHU3.56/18KT	3	3-5/8	2	3/4	16	16d	3550	3550	3550	3550	6380	6380	6380	4815	FL
UMH458	--	3	4-5/8	2	3/4	16	16d	3550	3550	3550	3550	6380	6380	6380	4815	
UMH538	--	3	5-3/8	2	3/4	16	16d	3550	3550	3550	3550	6380	6380	6380	4815	
UMH558	MBHU5.50/16KT, MBHU5.50/18KT	3	5-5/8	2	3/4	16	16d	3550	3550	3550	3550	6380	6380	6380	4815	
UMH718	--	3	7-1/8	2	3/4	16	16d	3550	3550	3550	3550	6380	6380	6380	4815	

1) Uplift loads have been increased 60% for wind or seismic loads; no further increase shall be permitted.  
 2) Fasten UMH hanger to concrete structure with (2) 3/4" dia. DeWalt Screw-Bolt™+ screw anchors or equal with 5" minimum embedment. Screw anchors shall be installed in masonry with grouted cells in accordance with manufacturer's installation specifications.  
 3) **NAILS:** 16d nails are 0.162" dia. x 3-1/2" long.